

TOL47 Series Thermostat User Guide

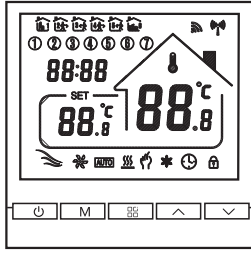

This thermostat is used for water heating, electric heating, or gas boiler.

Wiring Diagram

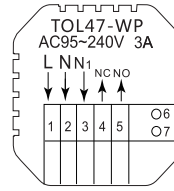

WP: Water heating

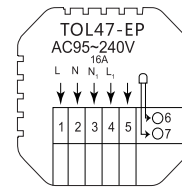

EP: Electric heating

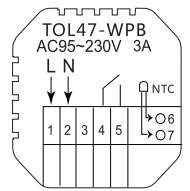

WPB: Gas boiler heating

03

Welcome

Thank you for your trust and support!

We have adopted advanced technology and perfect craftsmanship so that your new thermostat will provide you with a suitable temperature environment every day in the future. It makes your life more pleasant and artistic and making your living environment more fashionable aesthetic.

For detailed instructions on installing and using this thermostat, please read this manual carefully.

Please get in touch with a professional to install the thermostat for you. Besides, please install and use this product within the scope of the law.

Application

The intelligent digital humidity controller is a floor heating system suitable for room temperature control and household temperature control. It controls the operating status of the floor heating equipment by sensing the comparison between the ambient temperature and the set temperature. While improving comfort, it achieves the purpose of energy saving.

The digital thermostat adopts microcomputer control technology and has an elegant design, and is easy to use. Moreover, it has manual and automatic functions, programmable functions, and state memory functions.

01

Mounting steps

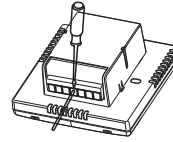

1. Connect the power box according to the wiring diagram

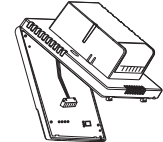

2. Separate the power supply from the control board cable

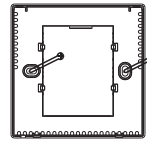

3. Screw the power supply into the box of 86

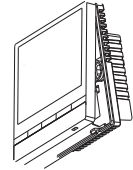

4. Connect the power board to the control board line, and align the buckle at 30 degrees to complete the installation.

04

Product packaging

Thermostat host	1 PC
Certificate of conformity	2PCS
Sensing line (optional)	1PC

Product parameters

WP : Water heating 3A;
EP : Electric heating 16A
WPB : Linkage; M: Gas boiler 3A

Electrical Specifications:

- Temperature Sensor: NTC
- Temperature accuracy: $\pm 1^{\circ}\text{C}$
- Display screen: LCD
- Working environment: $-5\text{--}50^{\circ}\text{C}$
- Self-consumption power: $< 1\text{W}$
- Temperature setting: $5\text{--}60^{\circ}\text{C}$
- Display range: $0\text{--}51^{\circ}\text{C}$
- Load current: water heater 3A
electric heater 16A
gas boiler heater 3A
- Voltage: AC95- 220V, 50/60Hz

02

Icon description

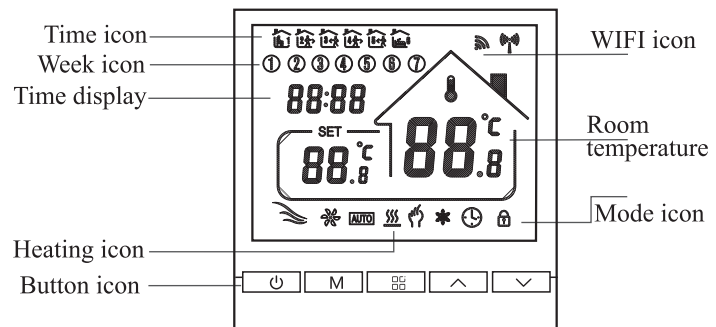

05

Operation Guide

1. Power on/off: press the key to turn on/off the thermostat.
2. Press the M key to switch between manual and automatic modes.
3. In the automatic mode, press the key or key to adjust the temperature, and it will enter the automatic mode, which only runs for a while.
4. Press the key to enter the clock setting, press the mode key M to switch the setting options, and press the up and down keys to adjust each parameter value.
Note: The time of the WIFI model will automatically obtain the Internet time.
5. Simultaneously press and hold the up and down keys for 5 seconds to add or cancel the childlock.
6. WIFI link: When the thermostat is turned on, press and hold the up button for five to eight seconds, the WIFI icon flashes on the thermostat display, and the thermostat enters the code matching state.

06

Time programming instructions

Long press the M key to enter the programming setting, short press the M key to switch options, press the up or down key to adjust the parameters of each option, and press the 6 key to exit and save mode.

key	Options	Icon	Time	Time Adjustment	Defaults	Temperature adjustment	
	Working days	1		06:00		20°C	
		2		08:00		15°C	
		3		11:30		15°C	
		4		12:30		15°C	
		5		17:00		22°C	
		6		22:00		15°C	
	Holidays	1		08:00		22°C	
		2		23:00		15°C	

07

Advanced Option Setting

When POWER OFF, press the M key and the key for 5 seconds to enter the advanced setting.
Press the M key to enter the next option, then press the up and down key to adjust, press the key to exit the advanced option setting mode.

01	Temperature compensation	The default value of the calibration room temperature is -2°C. Press the up or down key to adjust the range from 9.9°C to -9.9°C.
02	Sensor selection	The temperature sensor selection defaults to IN. Press the up key or the down key to adjust it respectively as IN internal sensor selection. ALL means all internal sensors are selected; OUT means external sensors are set.
03	Limit temperature value modification	The limit temperature value is 35°C by default. Press the up or down key to adjust the range from 5°C to 60°C.
04	Temperature difference setting	The default setting temperature difference start is 1°C; press the up or down key to adjust the range from 1°C to 10°C.
05	Antifreeze function	Set the antifreeze function as OFF by default; press the up key to turn on the antifreeze function.
06	Rest day selection	The default setting of rest days is double rest; press the up or down to adjust.
07	Main and auxilli reverse selection (optional)	Set the main and auxiliary reverse to 0 by default. Press the up or down key to adjust 0 to turn off the main and additional reverse function, and 02 to indicate the auxiliary reverse.
08	Passive linkage output delay time (optional)	Set the passive linkage delay time as 0 by default. Press the up or down key to adjust the range of 0-5 minutes.
09	Set temperature upper limit	Set the upper limit of the temperature to 60°C; press the up or down key to adjust the range from 35°C to 95°C.
10	Reset	Set to restore factory settings. The default display is "-," press the up key to display "----" and then press the enter key to restore the factory settings.

08

About WIFI connection

Before using the WIFI temperature controller for the first time, you must set the WIFI value number and configuration via your smartphone or tablet, which will allow communication between your connected devices.

WIFI connection: When the thermostat is turned on, press and hold the up button for 5 seconds, the WIFI icon flashes on the thermostat display, and the thermostat enters the code matching state.

WIFI connection: Bluetooth thermostat, please turn on the phone's Bluetooth

1. APP download

Search for "Tuya Smart" in each APP market or scan the following QR code to download this software:



09

TOL47 Thermostat User Guide

2. Register an account

If you do not have an APP account, you can choose to register or log in via SMS verification code. Click "Create New Account" to enter the privacy policy page of Tuya Smart Platform. After clicking Agree, you will formally join the registration page of your mobile phone number.

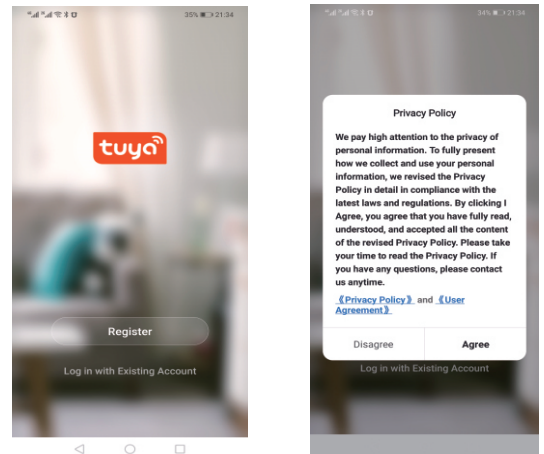

10

TOL47 Thermostat User Guide

The system automatically determines the current country/region, or you can manually select the country/region, enter your phone number or email address, and click "Get the Verification Code."

Enter the received verification code. Then enter the password. Click "Finish" to register successfully.

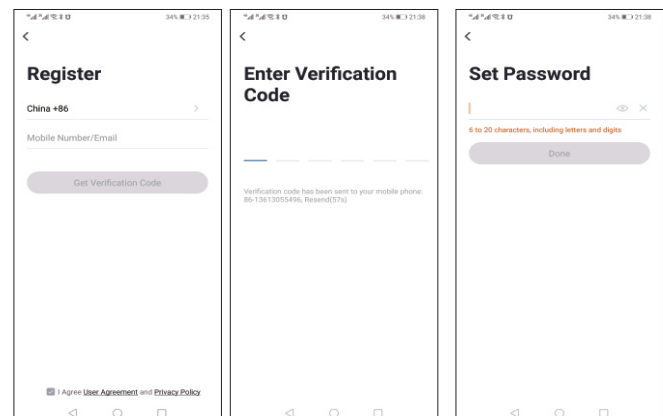

11

3. Add device

1: (Bluetooth connection) Turn on the mobile phone's Bluetooth, turn the device on, and enter the Tuya APP. Click "Add Device" or "+" on the top right of the APP homepage, and enter the "Add Device" interface. It will prompt: find the device to be added (Figure 2) and follow the prompts.

2: "Automatic discovery": Search for devices (Figure 3), and add widgets as prompted on the phone page

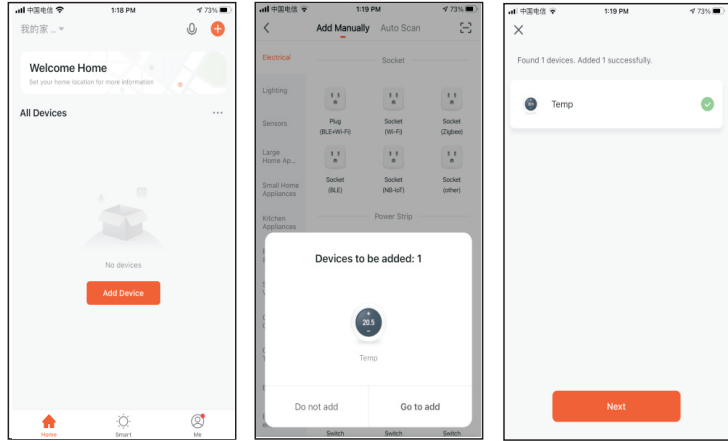

TOL47 Thermostat User Guide

3: (WIFI connection) When the thermostat is turned on, press and hold the up button for 5 seconds, the thermostat display will show Now the WIFI icon flashes (slow flashing), and the thermostat enters the status of code matching.

Find the temperature control product (Bluetooth + WIFI model) in the (small household appliances). In the specified network configuration mode, click the confirmation button on the page, select the WIFI that can connect to the Internet in the working area of the device, and enter it.

WIFI password, click Next, click according to the page prompt (Figure 2), "Go to connect," and follow the instructions to find the prompt content (Figure 3), click "Prompt content" and then return to the Tuya APP to enter the network configuration process.

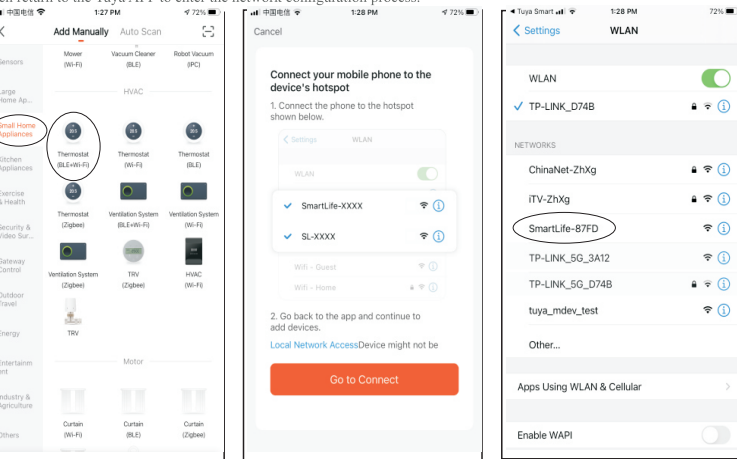

TOL47 Thermostat User Guide

In that case, the APP for the network configuration process is shown in Figure 1, and the network configuration successfully displays the interface shown in

Figure 2. The device's name with successful network configuration can be modified, and the room's location can also be selected.

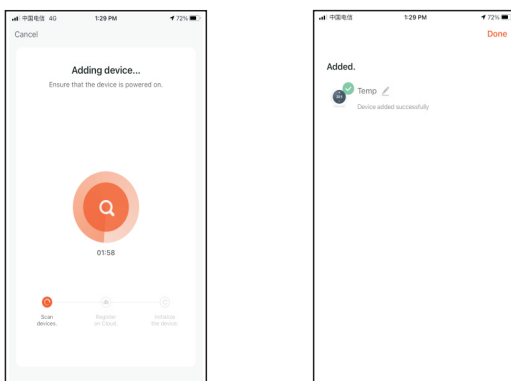

If the network configuration fails, the APP will display the page as shown in the figure below, and you can choose to add it again or view the help.

Note: Please confirm whether the thermostat enters the code matching state if the connection fails.

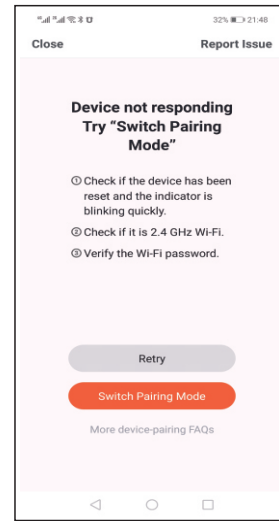

4. Thermostat APP interface display

